

### FOR USE IN

GT-N20/SL

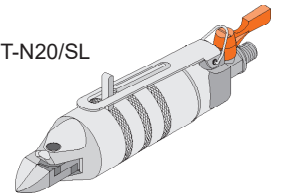

GT-NR20

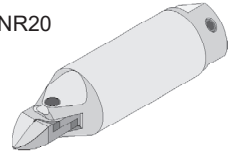

GT-NS20

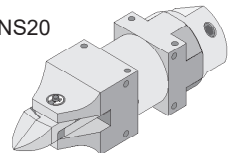

GT-NB20LW-10TM  
GT-NB20LW-10SM

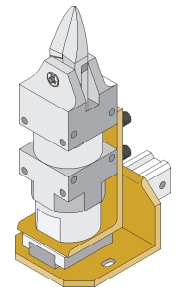

All dimensions are in millimeters (mm) unless otherwise noted

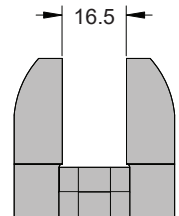

EFFECTIVE CUT:	18	APPLICATION:	PLASTIC
BLADE VARIATIONS		MATERIAL:	ALLOY STEEL
ALLOY STEEL:	N20ALL	EDP#	388006 - 128
CARBIDE:	CALL JDV	AKA:	
HIGH SPEED STEEL:	CALL JDV	Rev.	Rev. Date: 1.04.2021
EQUIVALENT / ALTERNATIVE TO:			

MODEL NO.	N20ALL
<b>VESSEL</b> PROFESSIONAL TOOLS	<b>NIPPER BLADE</b>
DRAWING #:	BLNI 1192

**VESSEL's Exclusive North American Distributor**

**Jdv** JDV Products Inc.  
22-01 Raphael Street, Fair Lawn, NJ 07410  
Tel: 201-796-1720 Fax: 201-796-9399  
www.vesseltools.com